

Harris County Appraisal District



0 100 200

PUBLICATION DATE:
10/1/2011

Geospatial or map data maintained by the Harris County Appraisal District is for informational purposes and may not be prepared for or be suitable for legal, engineering, or surveying purposes. It does not represent an on-the-ground survey and only represents the approximate location of property boundaries.

MAP LOCATION

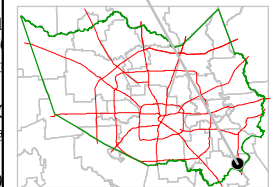

FACET 6250A

1	2	3	4
5	6	7	8
9	10	11	12

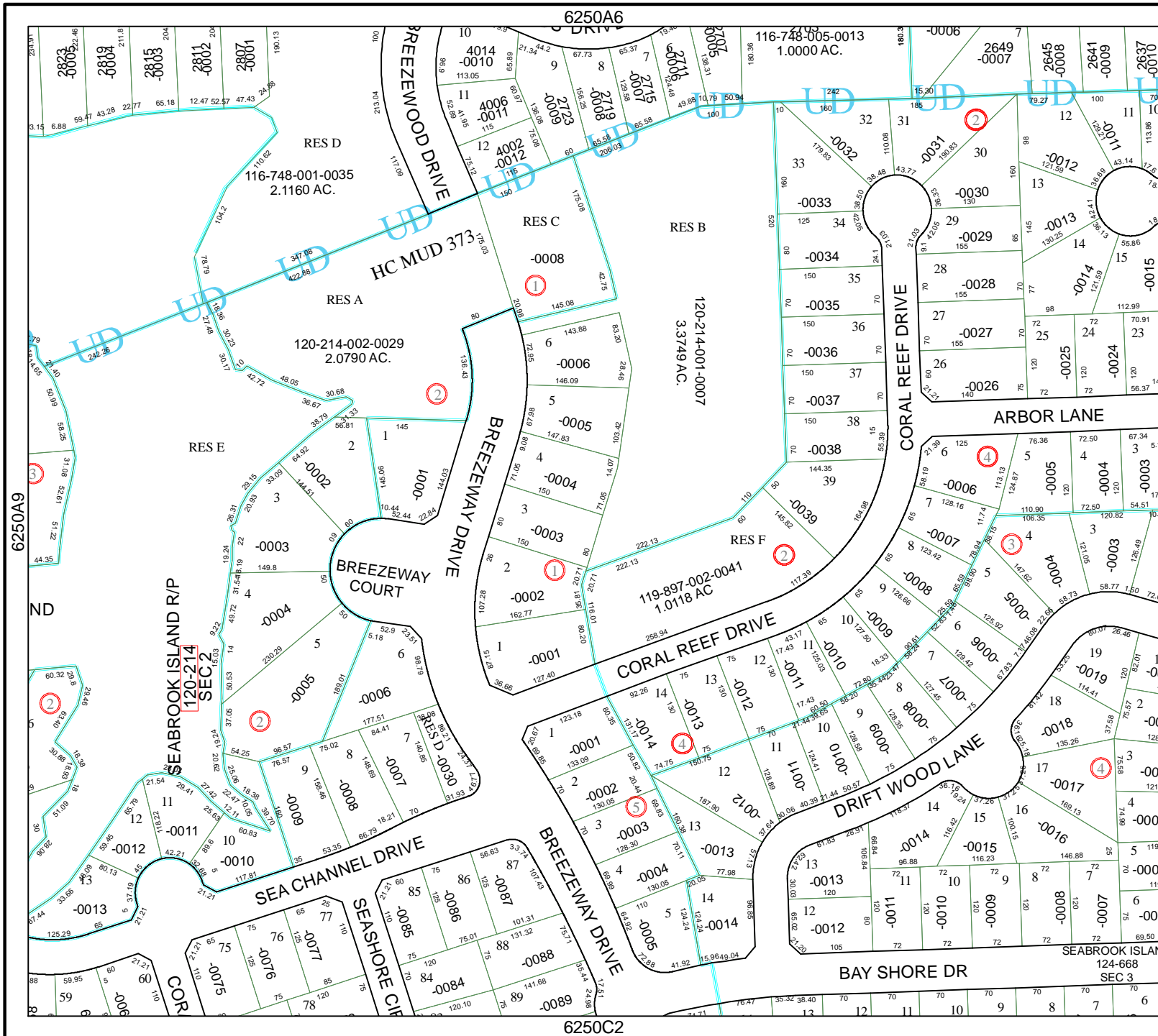

6250A9

ND

6250A6

6250A11

6250C2