

6167B3

10C

042-159-000-0043  
25.5500 AC

10B

042-159-000-0042  
8.6430 AC

10A

HUFFMAN I.S.D.  
HC ESD 4 (EMS/ FIRE)  
HC ESD 5 (EMS)  
HC ESD 80 (FIRE)  
CROSBY I.S.D.

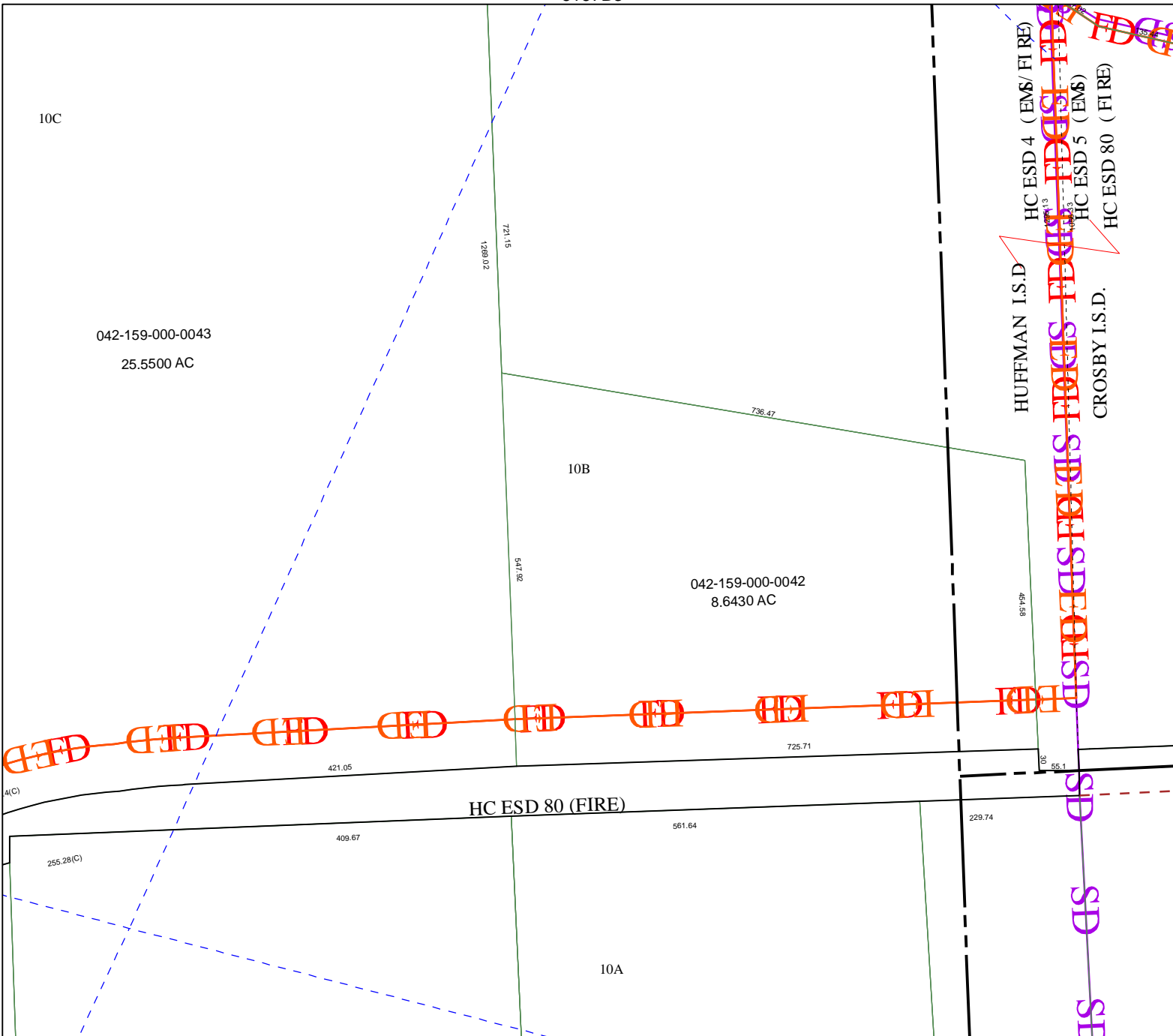

6167B6

# Harris County Appraisal District



0 100 200

PUBLICATION DATE:  
11/30/2011

Geospatial or map data maintained by the Harris County Appraisal District is for informational purposes and may not have been prepared for or be suitable for legal, engineering, or surveying purposes. It does not represent an on-the-ground survey and only represents the approximate location of property boundaries.



### MAP LOCATION

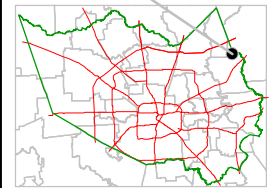

## FACET 6167B

1	2	3	4
5	6	7	8
9	10	11	12

6167B11

6167B8