

6066D5

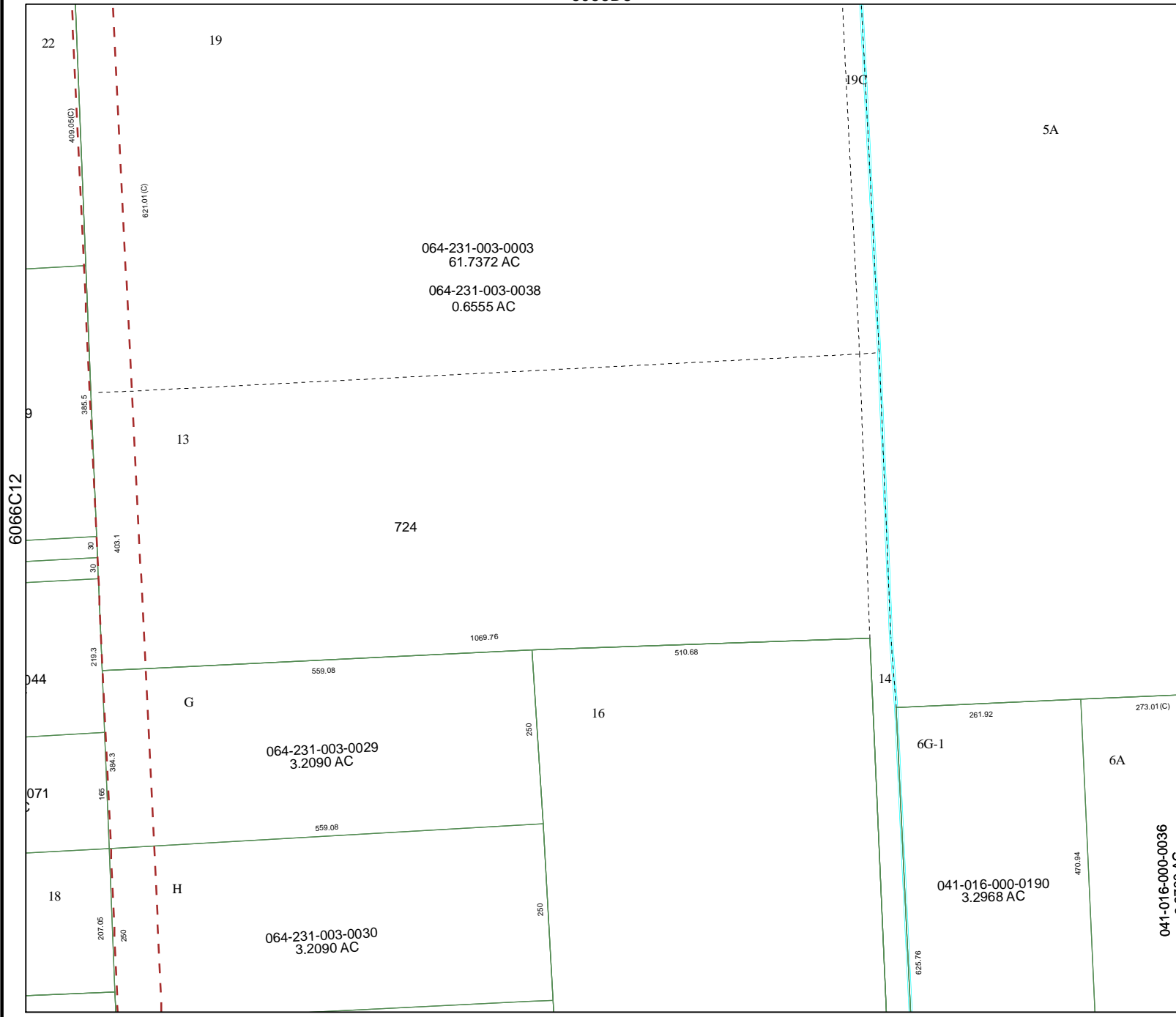

Harris County Appraisal District



0 100 200
PUBLICATION DATE:
 1/20/2012

Geospatial or map data maintained by the Harris County Appraisal District is for informational purposes and may **not** have been prepared for or be suitable for legal, engineering, or surveying purposes. It does **not** represent an on-the-ground survey and only represents the approximate location of property boundaries.



MAP LOCATION

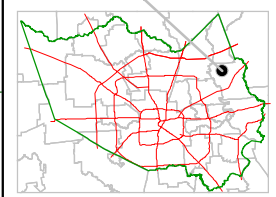

FACET 6066D

1	2	3	4
5	6	7	8
9	10	11	12

6065B1

6066C12

6066D10

041-016-000-0036