

5970C3

1W

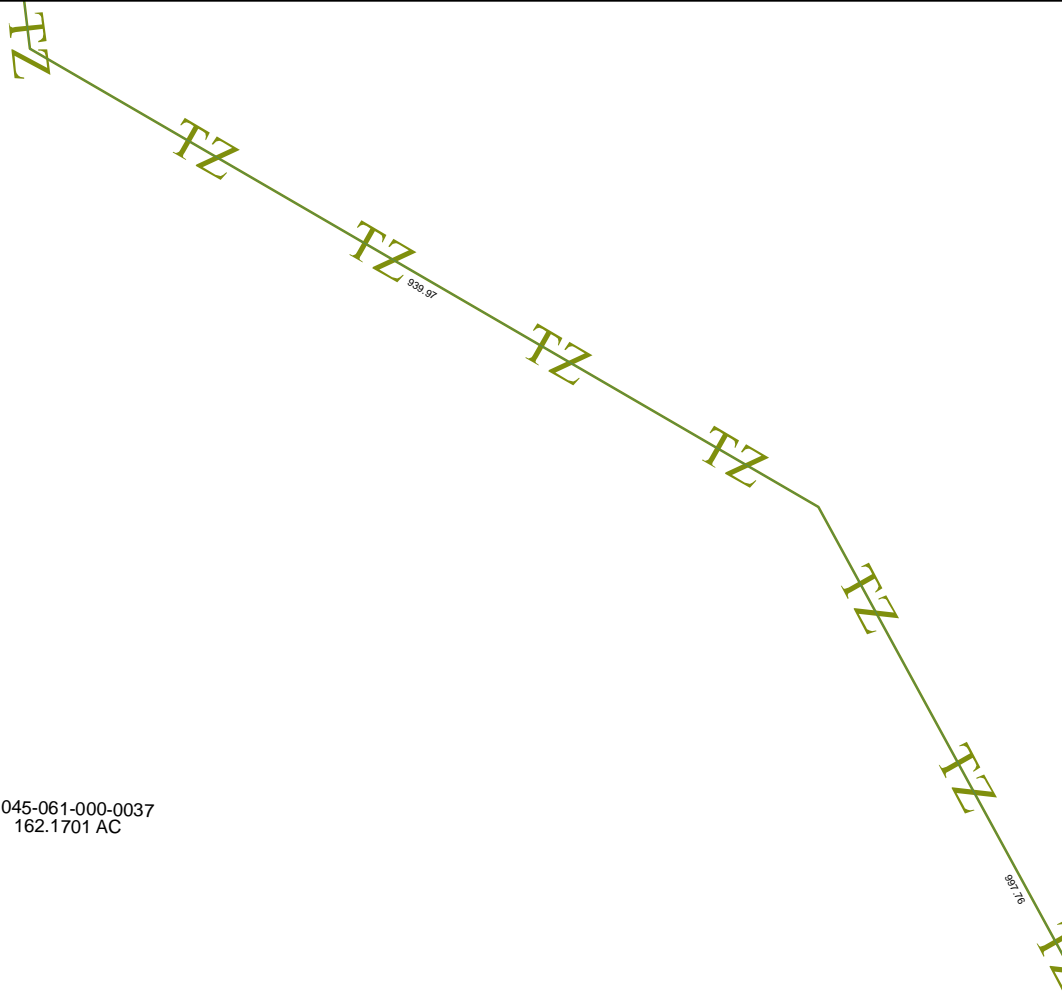

045-061-000-0037
162.1701 AC

5970C6

1R

1W
5970C11

Harris County Appraisal District

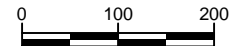

PUBLICATION DATE:
7/1/2011

Geospatial or map data maintained by the Harris County Appraisal District is for informational purposes and may **not** have been prepared for or be suitable for legal, engineering, or surveying purposes. It does **not** represent an on-the-ground survey and only represents the approximate location of property boundaries.



5970C8

MAP LOCATION

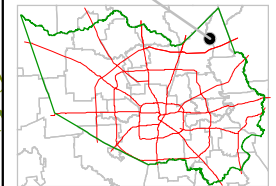

FACET 5970C

1	2	3	4
5	6	7	8
9	10	11	12