

5960D2

045-037-000-0085
115.8744 AC

5960D5

Harris County Appraisal District



0 100 200

PUBLICATION DATE:
1/19/2012

Geospatial or map data maintained by the Harris County Appraisal District is for informational purposes and may **not** have been prepared for or be suitable for legal, engineering, or surveying purposes. It does **not** represent an on-the-ground survey and only represents the approximate location of property boundaries.



MAP LOCATION

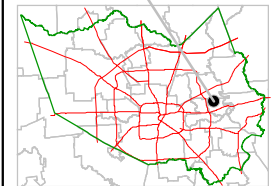

FACET 5960D

1	2	3	4
5	6	7	8
9	10	11	12

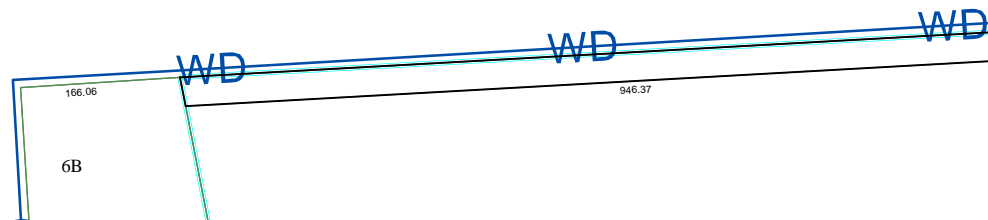

5960D10

5960D7