

5869C2

5869C5

1A
1717
045-061-000-0003
52.8710 AC.

427.06

5869C10

RES F

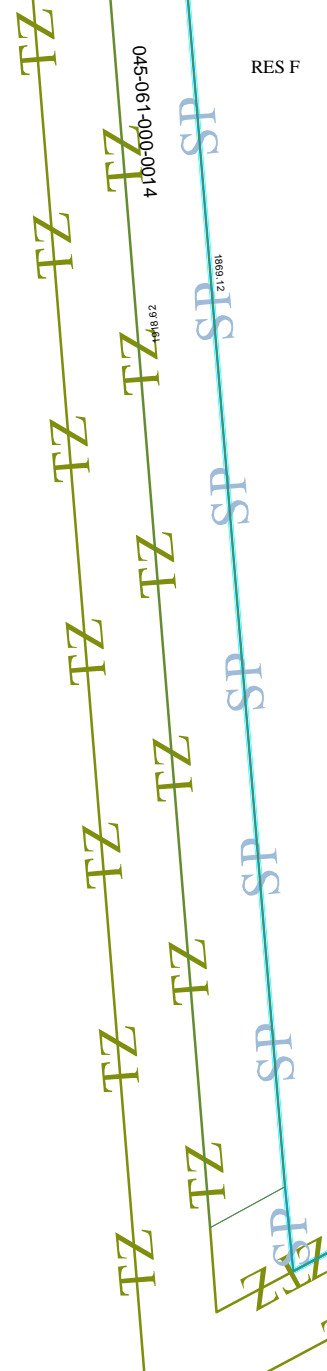

Harris County Appraisal District



0 100 200
PUBLICATION DATE:
6/1/2011

Geospatial or map data maintained by the Harris County Appraisal District is for informational purposes and may not have been prepared for or be suitable for legal, engineering, or surveying purposes. It does not represent an on-the-ground survey and only represents the approximate location of property boundaries.



MAP LOCATION

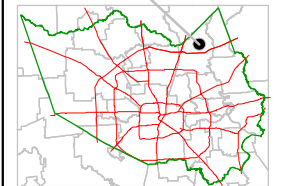

FACET 5869C

1	2	3	4
5	6	7	8
9	10	11	12

5869C7