

Harris County Appraisal District



0 100 200
PUBLICATION DATE:
 1/11/2012

Geospatial or map data maintained by the Harris County Appraisal District is for informational purposes and may not be prepared for or be suitable for legal, engineering, or surveying purposes. It does not represent an on-the-ground survey and only represents the approximate location of property boundaries.



MAP LOCATION

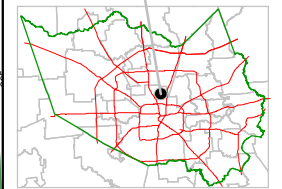

FACET 5461A

1	2	3	4
5	6	7	8
9	10	11	12

5461A6

5461C2

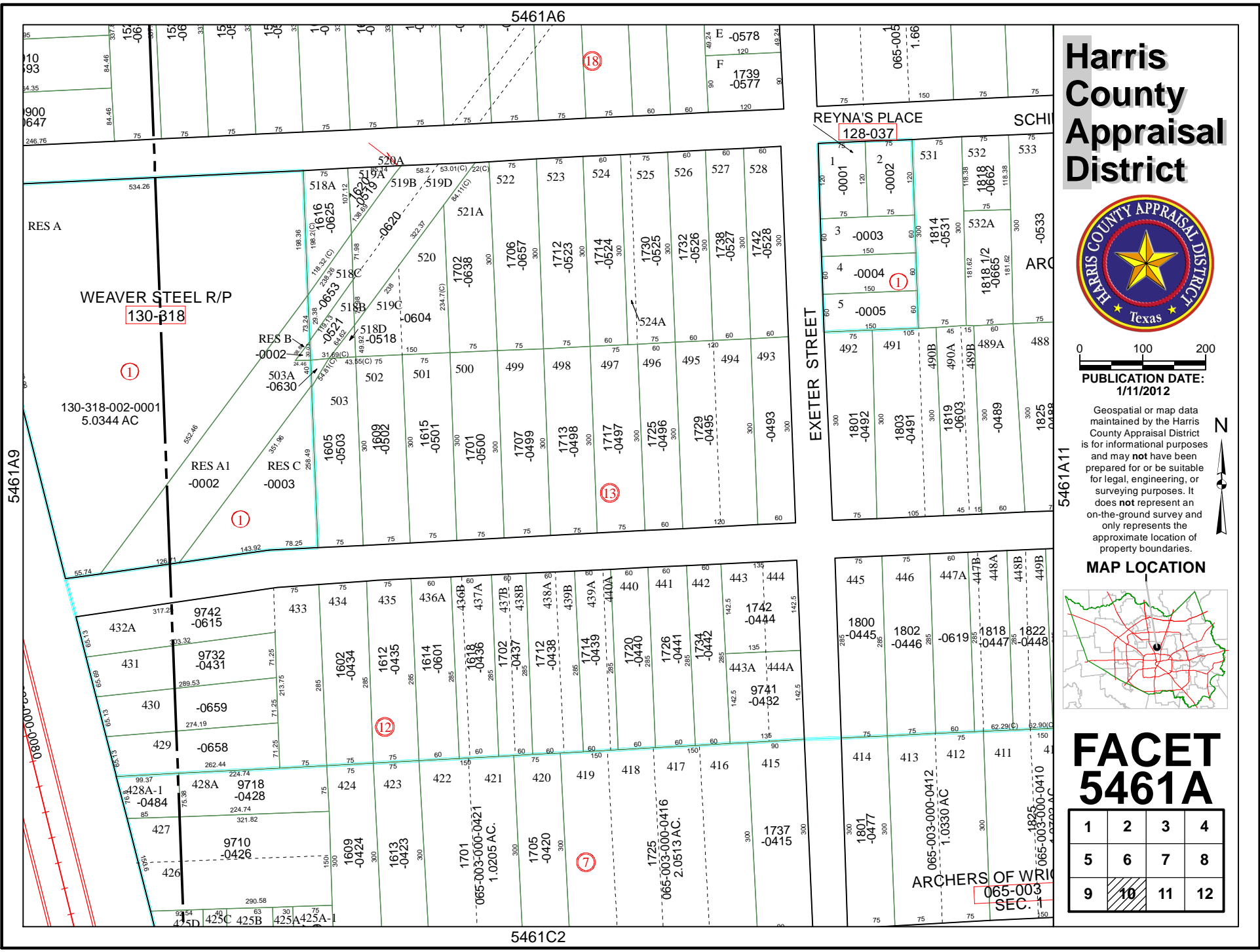

RES A

WEAVER STEEL R/P

130-318

130-318-002-0001
 5.0344 AC

RES B

RES A1

RES C

REYNA'S PLACE

SCHIEFFELIN

128-037

EXETER STREET

ARCHERS OF WRITING

065-003

SEC. 1

1

1

18

13

12

7

5461A11

5461A9

0800-000-000

425D 425C 425B 425A

425A-1

425A-1

425A-1

425A-1

425A-1

425A-1

425A-1

425A-1

425A-1

425A-1

425A-1

425A-1

425A-1

425A-1

425A-1

425A-1

425A-1

425A-1

425A-1

425A-1

425A-1

425A-1

425A-1

425A-1

425A-1

425A-1

425A-1

425A-1

425A-1

425A-1

425A-1

425A-1

425A-1

425A-1

425A-1

425A-1

425A-1

425A-1

425A-1

425A-1

425A-1

425A-1

425A-1

425A-1

425A-1

425A-1

425A-1

425A-1

425A-1

425A-1

425A-1

425A-1

425A-1

425A-1

425A-1

425A-1

425A-1

425A-1

425A-1

425A-1

425A-1

425A-1

425A-1

425A-1

425A-1

425A-1

425A-1

425A-1

425A-1

425A-1

425A-1

425A-1

425A-1

425A-1

425A-1

425A-1

425A-1

425A-1

425A-1

425A-1

425A-1

425A-1

425A-1

425A-1

425A-1

425A-1

425A-1

425A-1

425A-1

425A-1

425A-1

425A-1

425A-1

425A-1

425A-1

425A-1

425A-1

425A-1

425A-1

425A-1

425A-1

425A-1

425A-1

425A-1

425A-1

425A-1

425A-1

425A-1

425A-1

425A-1

425A-1

425A-1

425A-1

425A-1

425A-1

425A-1

425A-1

425A-1

425A-1

425A-1

425A-1

425A-1

425A-1

425A-1

425A-1

425A-1

425A-1

425A-1

425A-1

425A-1

425A-1

425A-1

425A-1

425A-1

425A-1

425A-1

425A-1

425A-1

425A-1

425A-1

425A-1

425A-1

425A-1

425A-1

425A-1

425A-1

425A-1

425A-1

425A-1

425A-1

425A-1

425A-1

425A-1

425A-1

425A-1

425A-1

425A-1

425A-1

425A-1

425A-1

425A-1

425A-1

425A-1

425A-1

425A-1

425A-1

425A-1

425A-1

425A-1

425A-1

425A-1

425A-1

425A-1

425A-1

425A-1

425A-1

425A-1

425A-1

425A-1

425A-1

425A-1

425A-1

425A-1

425A-1

425A-1

425A-1

425A-1

425A-1

425A-1

425A-1

425A-1

425A-1

425A-1

425A-1

425A-1

425A-1

425A-1

425A-1

425A-1

425A-1

425A-1

425A-1

425A-1

425A-1

425A-1

425A-1

425A-1

425A-1

425A-1

425A-1

425A-1

425A-1

425A-1

425A-1

425A-1

425A-1

425A-1

425A-1

425A-1

425A-1

425A-1

425A-1

425A-1

425A-1

425A-1

425A-1

425A-1

425A-1

425A-1

425A-1

425A-1

425A-1

425A-1

425A-1

425A-1

425A-1

425A-1

425A-1

425A-1

425A-1

425A-1

425A-1

425A-1

425A-1

425A-1