

5363A8

5363C4

Harris County Appraisal District



0 100 200
PUBLICATION DATE:
1/23/2012

Geospatial or map data maintained by the Harris County Appraisal District is for informational purposes and may not have been prepared for or be suitable for legal, engineering, or surveying purposes. It does not represent an on-the-ground survey and only represents the approximate location of property boundaries.

MAP LOCATION

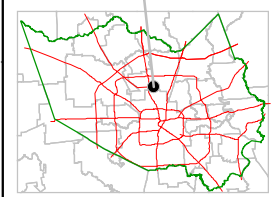

FACET 5363A

1	2	3	4
5	6	7	8
9	10	11	12

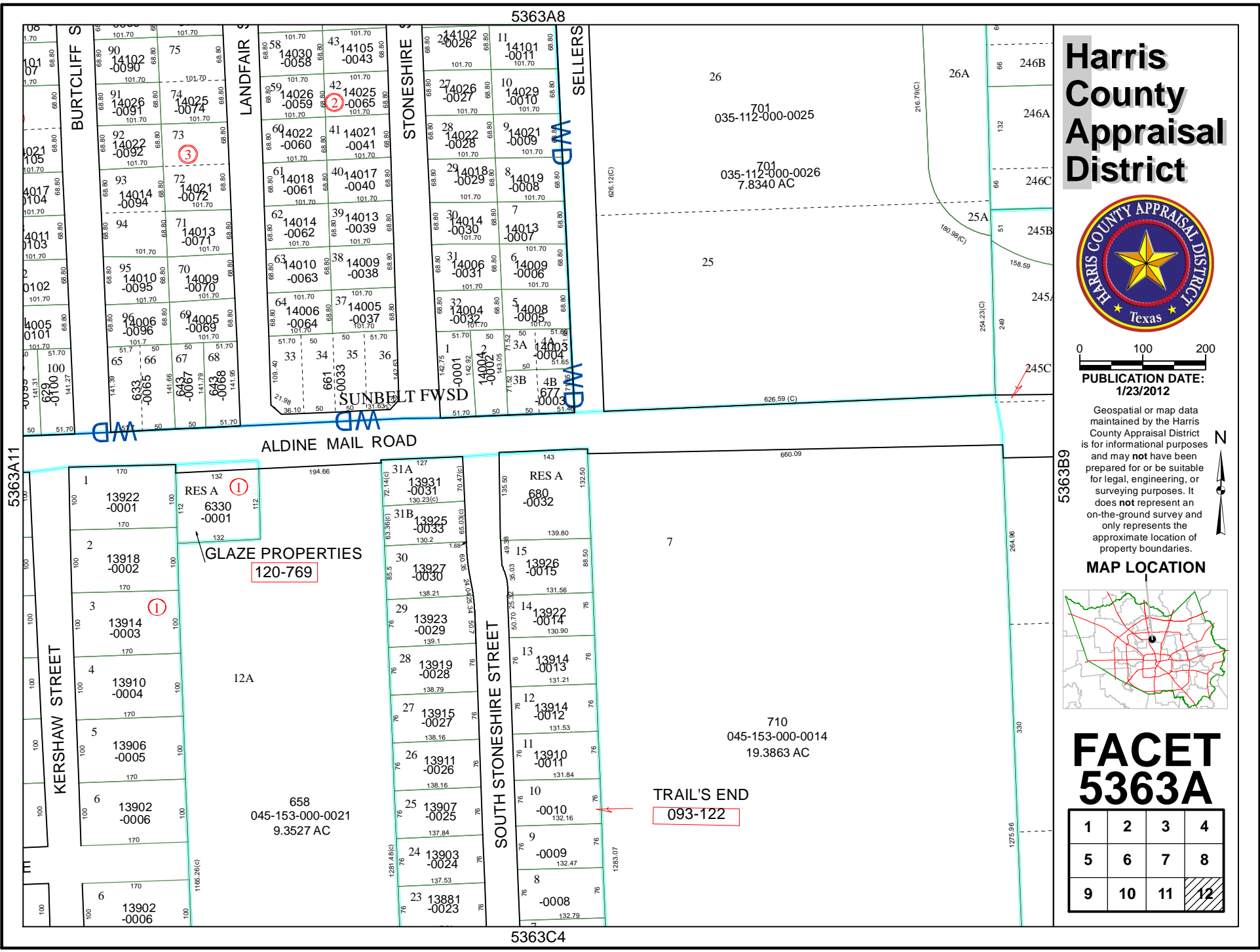

GLAZE PROPERTIES
120-769

TRAIL'S END
093-122

