

Harris County Appraisal District



0 100 200
 PUBLICATION DATE:
 8/12/2011

Geospatial or map data maintained by the Harris County Appraisal District is for informational purposes and may not be prepared for or be suitable for legal, engineering, or surveying purposes. It does not represent an on-the-ground survey and only represents the approximate location of property boundaries.

MAP LOCATION

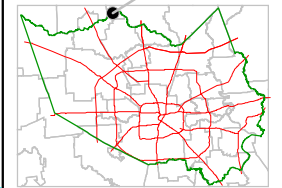

FACET 4974C

1	2	3	4
5	6	7	8
9	10	11	12

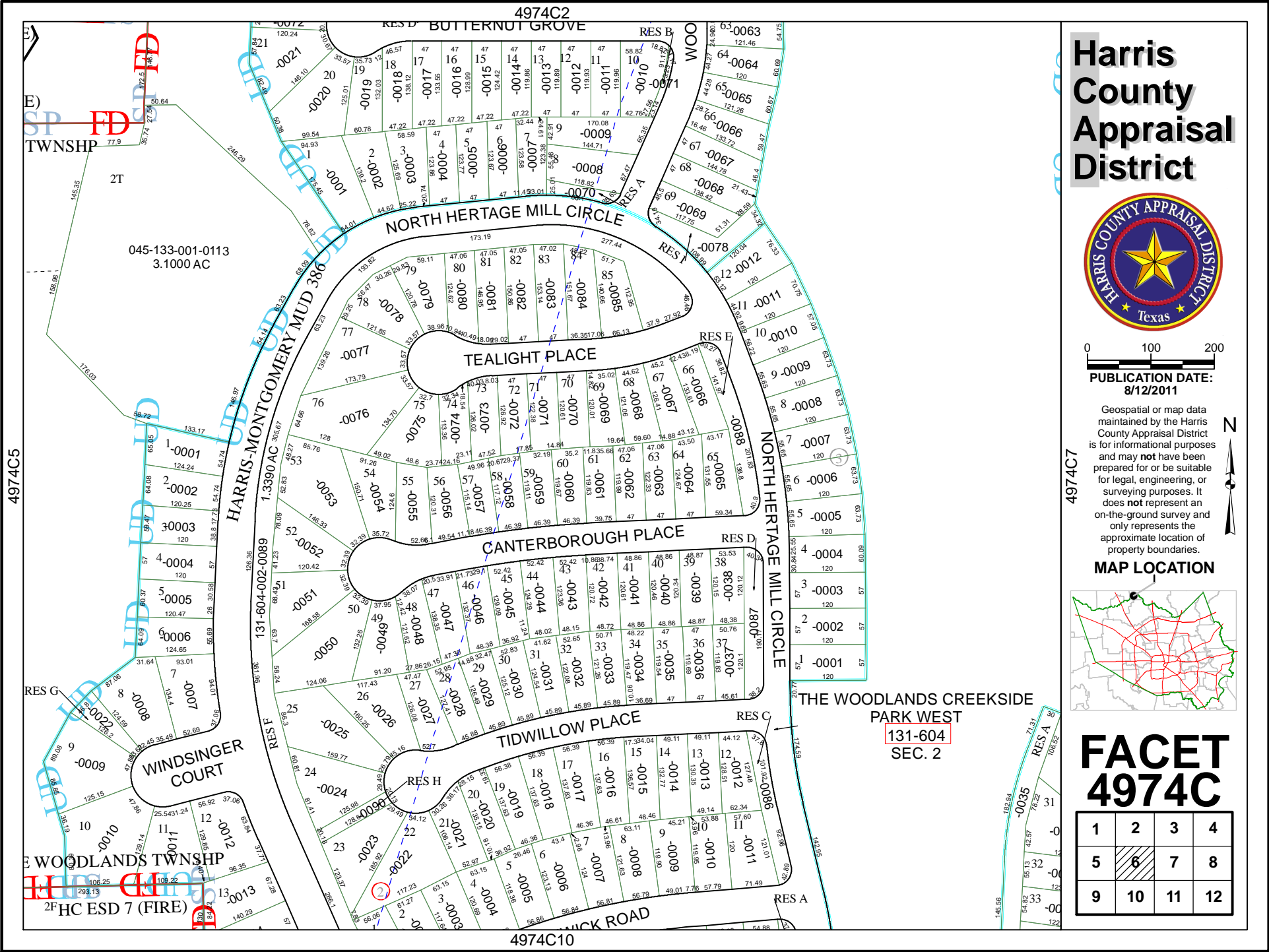

THE WOODLANDS CREEK SIDE
 PARK WEST
 131-604
 SEC. 2

4974C10

4974C5

4974C7

045-133-001-0113
 3.1000 AC

WINDSINGER COURT

E WOODLANDS TOWNSHIP

2F HC ESD 7 (FIRE)

