

4956C1

Harris County Appraisal District



0 100 200
PUBLICATION DATE:
1/20/2012

Geospatial or map data maintained by the Harris County Appraisal District is for informational purposes and may not have been prepared for or be suitable for legal, engineering, or surveying purposes. It does not represent an on-the-ground survey and only represents the approximate location of property boundaries.



MAP LOCATION

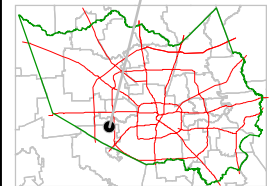

FACET 4956C

1	2	3	4
5	6	7	8
9	10	11	12

4956C9

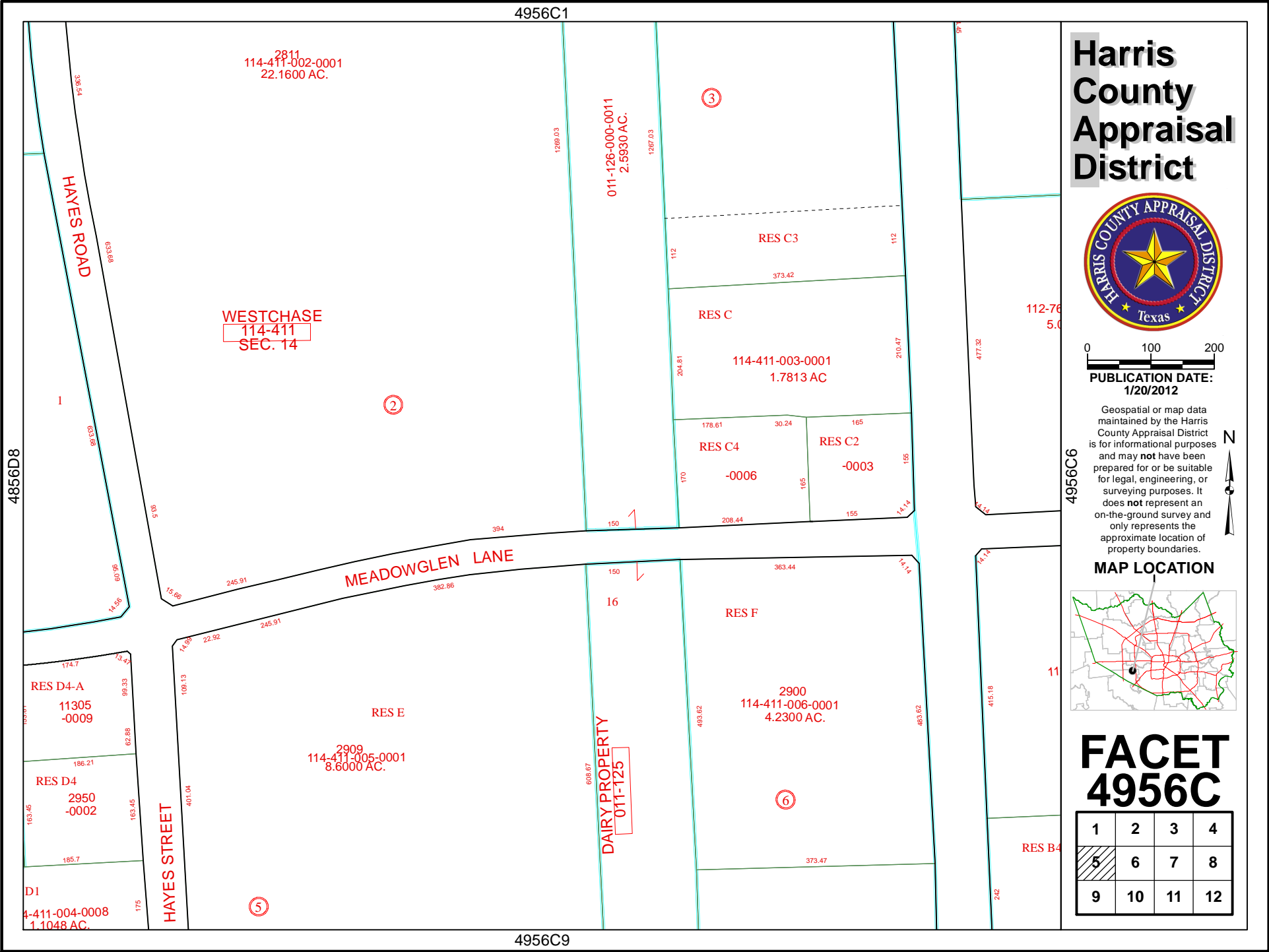

4856D8

4956C6

11

RES B4

2811
114-411-002-0001
22.1600 AC.

011-126-000-0011
2.5930 AC.

WESTCHASE
114-411
SEC. 14

114-411-003-0001
1.7813 AC

2909
114-411-005-0001
8.6000 AC.

2900
114-411-006-0001
4.2300 AC.

DAIRY PROPERTY
011-125

RES D4-A
11305
-0009

RES D4
2950
-0002

D1
114-411-004-0008
1.1048 AC.