

Harris County Appraisal District



PUBLICATION DATE:
1/20/2012

Geospatial or map data maintained by the Harris County Appraisal District is for informational purposes and may not have been prepared for or be suitable for legal, engineering, or surveying purposes. It does not represent an on-the-ground survey and only represents the approximate location of property boundaries.

MAP LOCATION

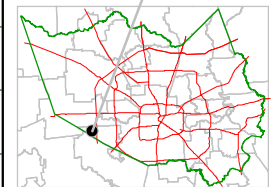

FACET 4755A

1	2	3	4
5	6	7	8
9	10	11	12

4755A1

118-191-001-0062
2.9961 AC

H.C.M.U.D. 120

4755A9

15250
115-473-000-0020
9.5000 AC.

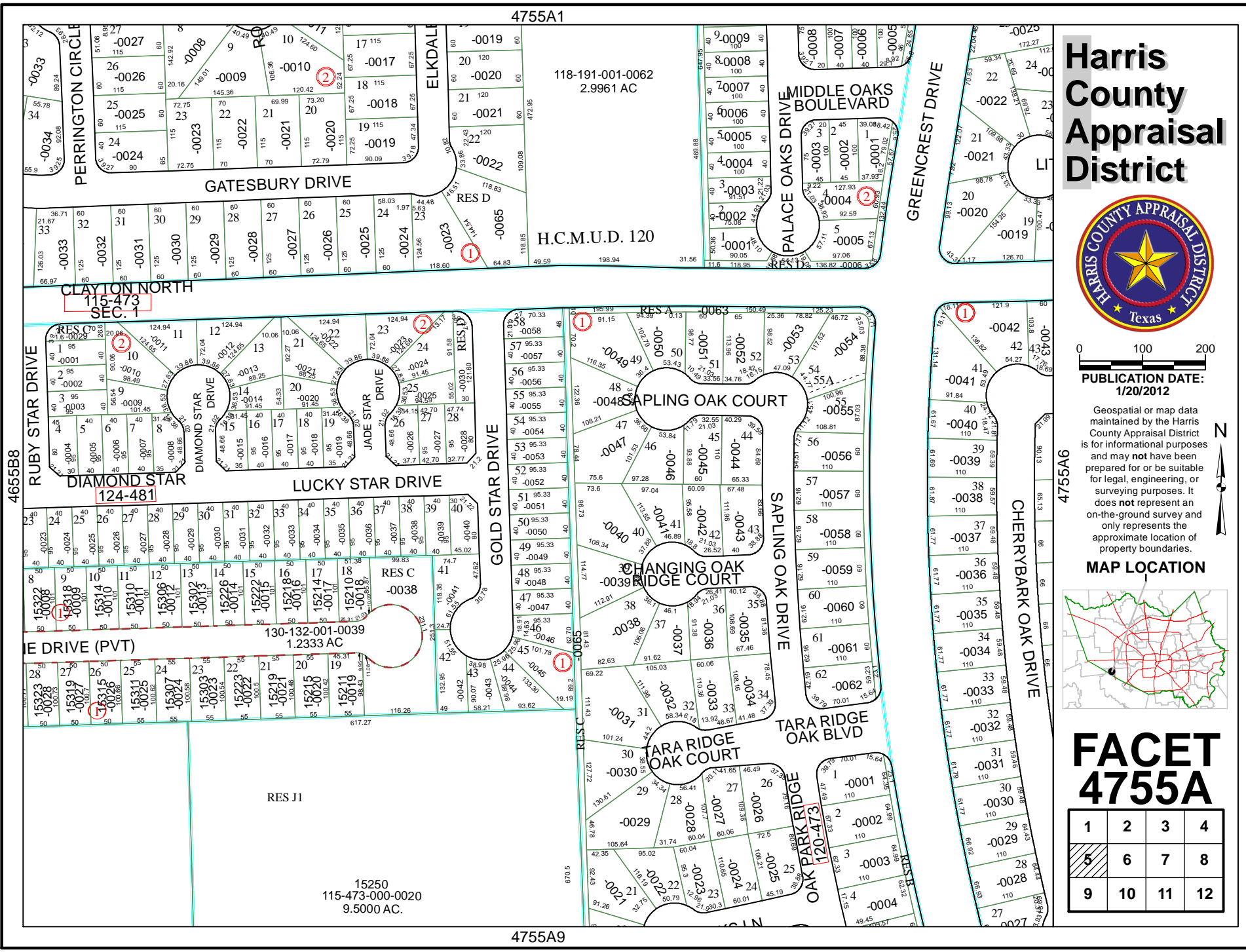

CLAYTON NORTH
115-473
SEC. 1

DIAMOND STAR
124-481

E DRIVE (PVT)
130-132-001-0039
1.2333 AC

RES J1

4655B8

4755A7

