

4568C9

4467B4

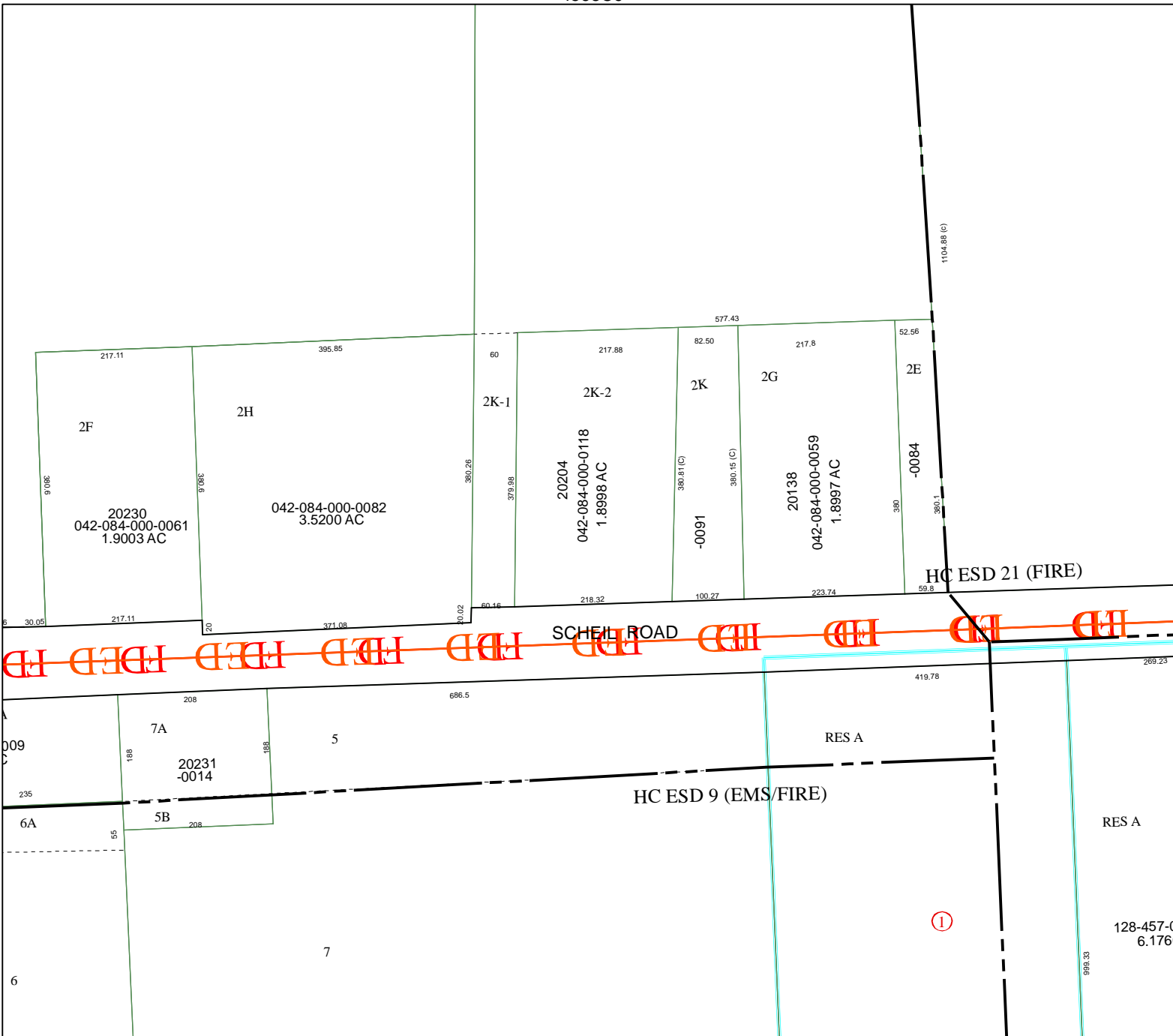

4567A5

Harris County Appraisal District

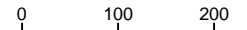

PUBLICATION DATE:
2/6/2012

Geospatial or map data maintained by the Harris County Appraisal District is for informational purposes and may **not** have been prepared for or be suitable for legal, engineering, or surveying purposes. It does **not** represent an on-the-ground survey and only represents the approximate location of property boundaries.



4567A2

MAP LOCATION

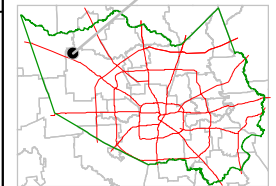

FACET 4567A

1	2	3	4
5	6	7	8
9	10	11	12

128-457-00
6.1760

①