

Harris County Appraisal District



0 100 200
 PUBLICATION DATE:
 12/6/2011

Geospatial or map data maintained by the Harris County Appraisal District is for informational purposes and may not have been prepared for or be suitable for legal, engineering, or surveying purposes. It does not represent an on-the-ground survey and only represents the approximate location of property boundaries.

MAP LOCATION

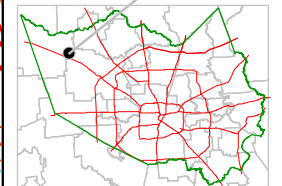

FACET 4467B

1	2	3	4
5	6	7	8
9	10	11	12

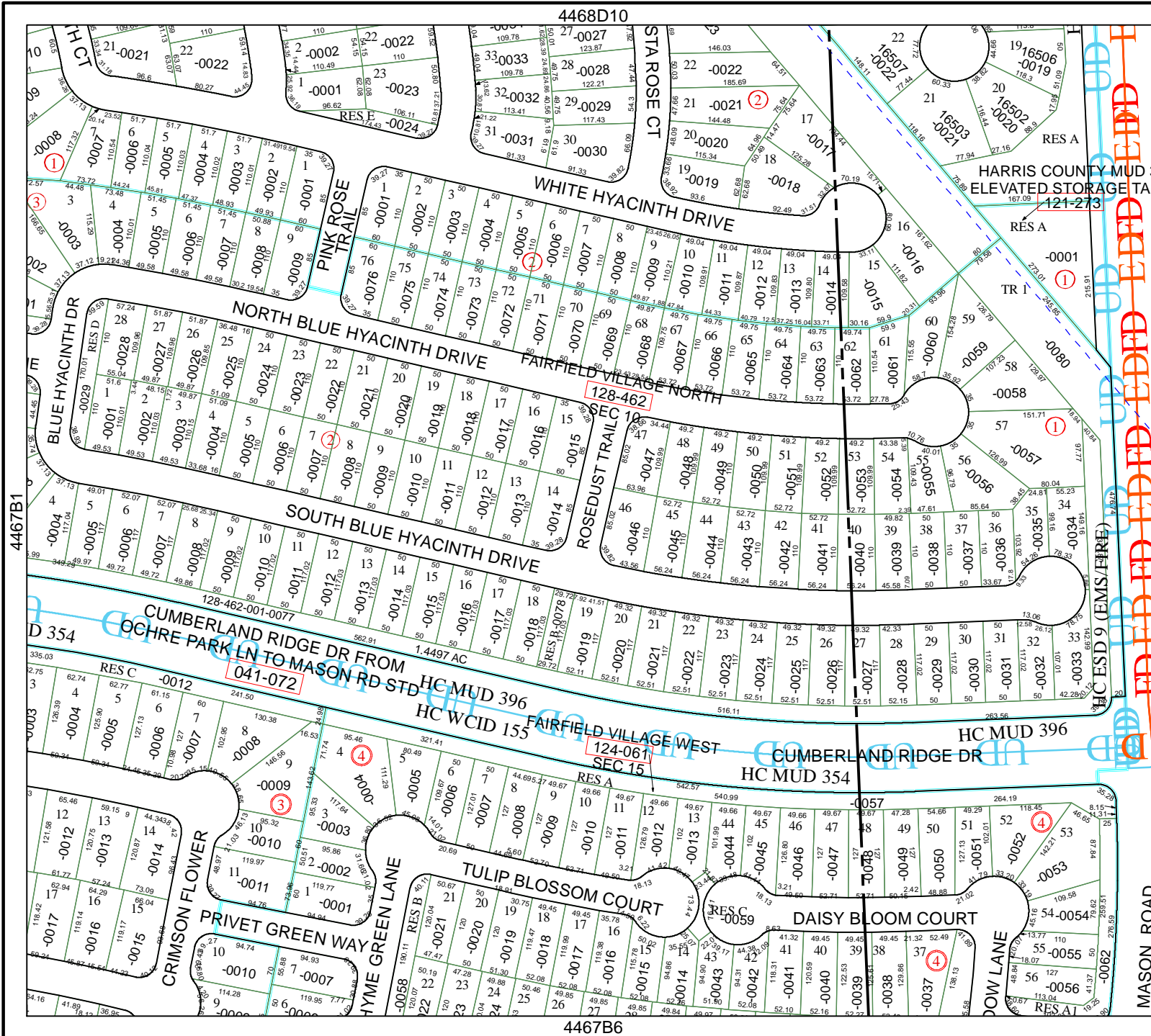

4468D10

128-462

124-061

4467B6

4467B3

MASON ROAD

4467B1

