

4466A1

4366B8

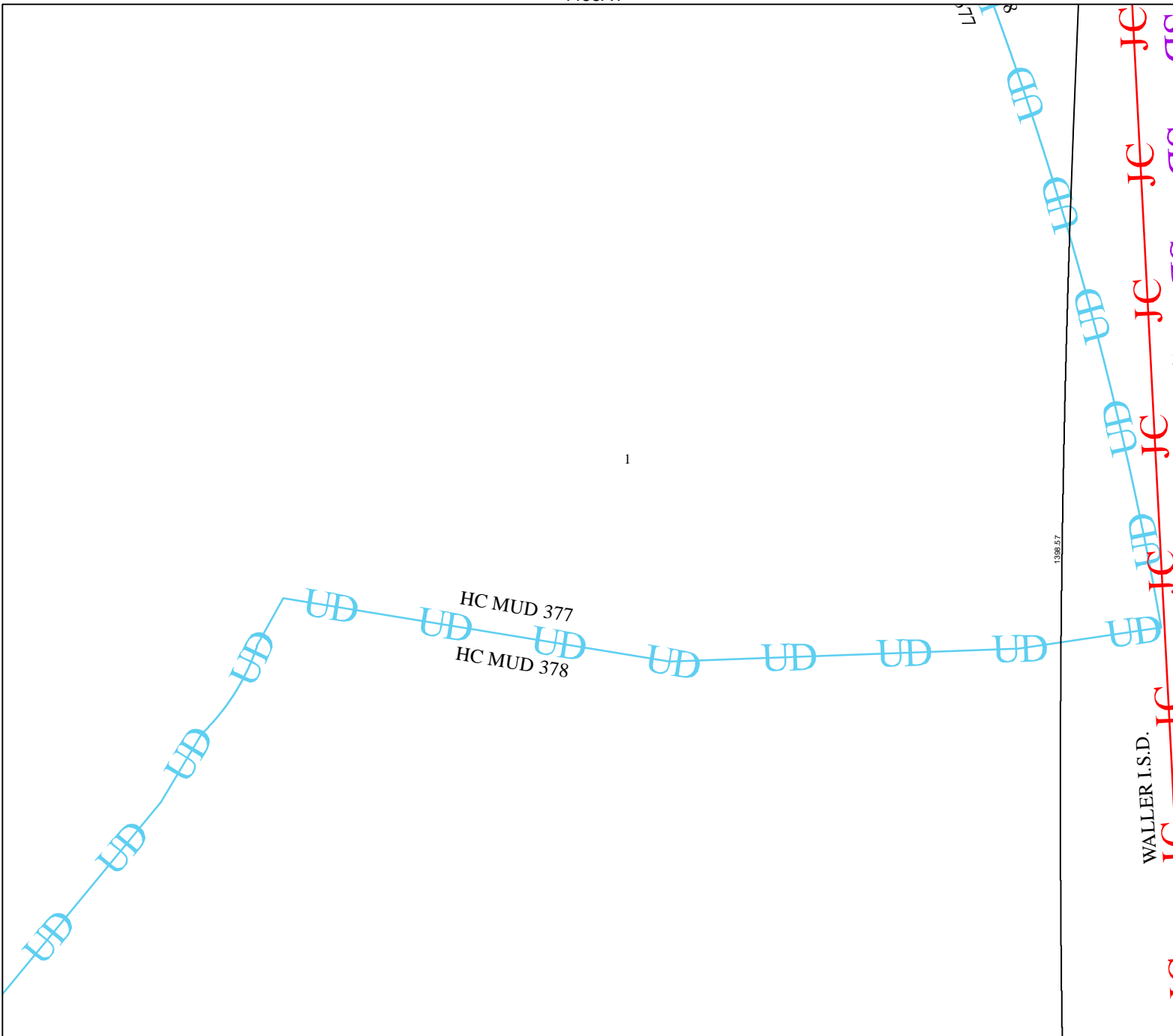

Harris County Appraisal District



0 100 200
PUBLICATION DATE:
 9/23/2011

Geospatial or map data maintained by the Harris County Appraisal District is for informational purposes and may **not** have been prepared for or be suitable for legal, engineering, or surveying purposes. It does **not** represent an on-the-ground survey and only represents the approximate location of property boundaries.



MAP LOCATION

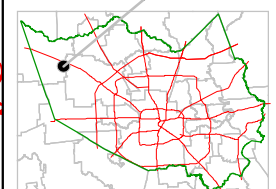

FACET 4466A

1	2	3	4
5	6	7	8
9	10	11	12

4466A9

1388.57

WALLER I.S.D.

4466A6